

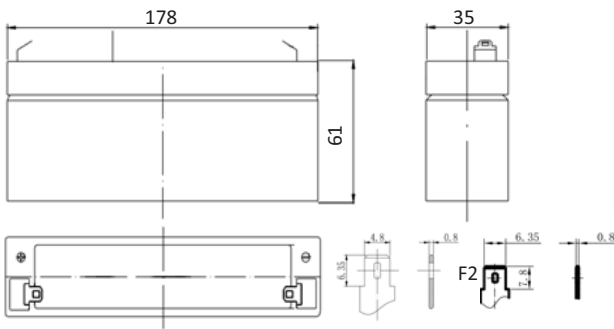

### AGM 12V2.2Ah

A market leader in battery power, the Valen brand, exclusive to Regal Electro, has been successfully used in both Australia & New Zealand for over 10 years. With a superior range of VRLA batteries, covering a variety of applications from basic stand-by to heavy cyclic, the Valen brand has proven benefits over cheaper alternatives, offering a real value for money!



#### SPECIFICATIONS

<b>Voltage</b>	12 Volt nominal
<b>Number of cells</b>	6
<b>Design life</b>	5 years
<b>Nominal Capacity 25°C</b>	
20Hr rate (5.25V)	2.2Ah
10Hr rate (5.25V)	2Ah
5Hr rate (5.25V)	1.85Ah
<b>Dimensions</b>	178(L)x35(W)x61(H)
<b>Weight</b>	0.95Kg
<b>Plates</b>	Heavy Duty
<b>Terminal</b>	F1/F2
<b>Container/cover</b>	ABS
<b>Charge voltage</b>	Cycle: 2.35 vpc at 25°C Float: 2.25 vpc at 25°C
<b>Internal Resistance</b>	90mΩ 25°C - Fully charged Battery
<b>Electrolyte</b>	Sulphuric acid
<b>Vent</b>	Self-sealing
<b>Operating temperature:</b>	-20°C to +60°C

(However it is recommended that the batteries be operated in the temperature range of 20 to 30°C to obtain full life and optimum performance.)

#### Discharge Constant Current (Amperes at 25°C)

End Point Volts/Cell	15min	30min	1h	3h	5h	10h	20h
1.75V	3.44	2.18	1.25	0.55	0.37	0.20	0.11

#### Discharge Constant Power (Watts at 25°C)

End Point Volts/Cell	15min	30min	1h	3h	5h	10h	20h
1.75V	7.68	4.01	2.40	1.02	0.67	0.37	0.21

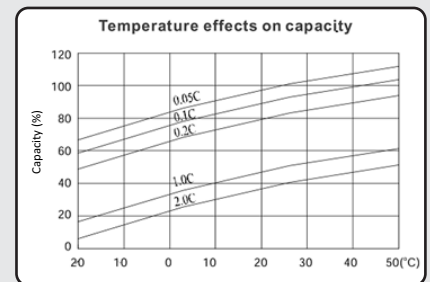
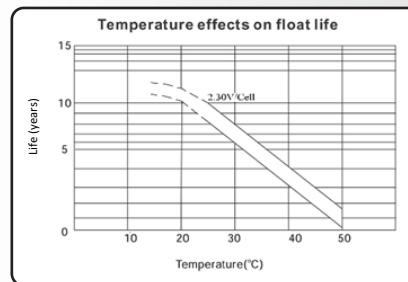
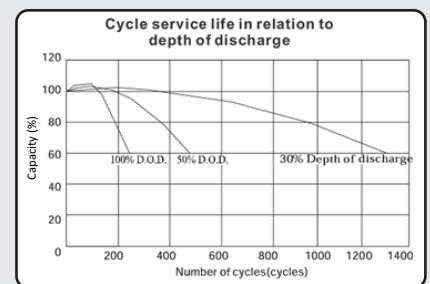
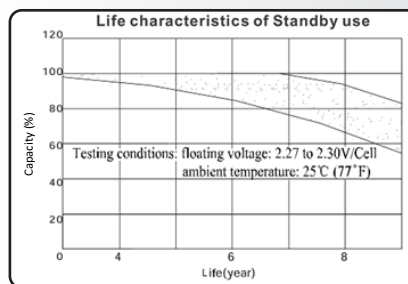
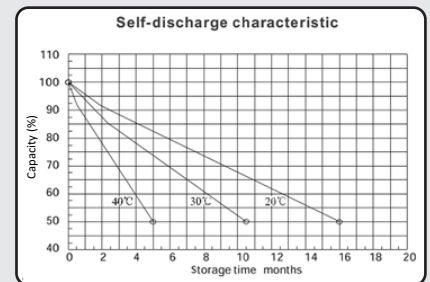
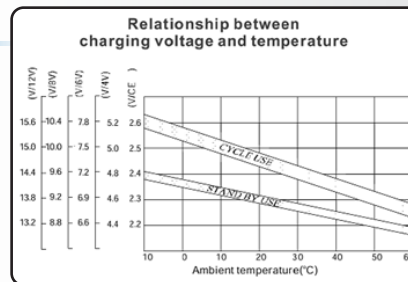
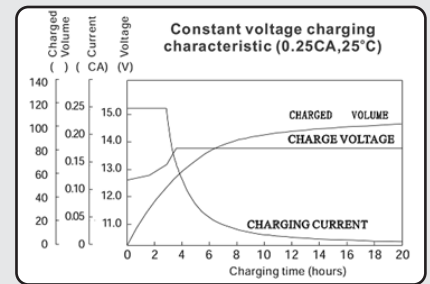
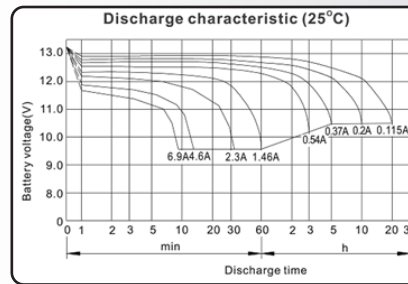

Specifications subject to change without notice.