

ALT 4KP. ALT 6KP

ELECTROMECHANICAL IRREVERSIBLE BARRIER WITH DOUBLE BUILT-IN FLASHING LIGHT FOR BAR FROM 4 TO 6 m, 24 Vdc

PLUS

On 6 m. model ALT has double spring to counter balance movement and make it more fluent, without bumps

Anti-UV orange peel epoxy power coating

Robust gears and levers for reliable functioning over time

Performance increase: 3,5 sec opening time for 4m barrier and 6 sec for 6 m barrier

Encoder for the obstacle detection and immediate run inversion

Linear acceleration and deceleration to make opening and closing run as smooth as possible

For an intensive use, for private and public solutions

Energy saving modality in stand by

Possibility to extract the control unit and program it in standing position for installer comfort and easy access

Compatible with new 230Vac control unit CT-724S, (pag. 110 for technical details)

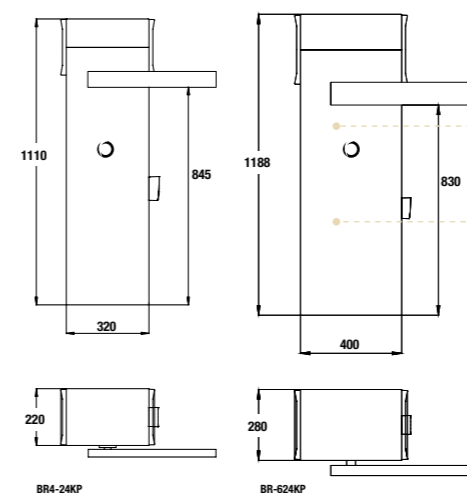

Metallic gear + shock resistant motor



Double Led flashing light

CODE	DESCRIPTION	PCS PALLET
BR4-24KP	24 Vdc motor, with control unit in box, encoder, double built-in led flashing light. Connector for receiver. For 4 m long barrier	6
BR-624KP	24 Vdc motor, with control unit in box, encoder, double built-in led flashing light. Connector for receiver. For 6 m long barrier	5

TECHNICAL DATA	BR4-24KP	BR-624KP
control unit	CT-724S	CT-724S
power	Vac (Vdc) 230 (24)	230 (24)
consumption power	W 150	150
motor rpm	rpm 1200	1200
motor consumption	A 6	6
opening time	sec 3.5	6*12
max bar length	m 4	6 *(8 mt)
working cycle	% 80	80
working temperature	°C -20° + 55°	-20° + 55°
weight	kg 35	43
protection degree	IP 54	54

* with 8m boom (AST8)

ACCESSORIES ALT 4KP ACCESSORIES ALT 6KP



AS4
Aluminum bar
L=4000 mm
di. 60x30 mm



AS-4J
2+2 m aluminum bar,
60x30x2 with joint included

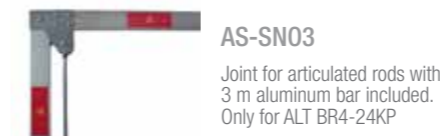

AS-SN03
Joint for articulated rods with
3 m aluminum bar included.
Only for ALT BR4-24KP



AST4
Aluminum tubular bar
L=4000 mm Ø 60 mm,
in case of strong wind



ATAST60
Connection for round
bar Ø 60 mm



CP-BR
Anchorage plate
with rag bolts



PROF
Flexible rubber profile,
8 m and plug set for AS4



AS6
Aluminum bar
L=6000 mm
di. 100 x 40 mm



AS-6J
3+3 m aluminum bar,
100x40x2 with joint included



AST6
Aluminum tubular bar
L=6000 mm Ø 90 mm,
in case of strong wind



AST8
Round telescopic aluminum boom
L=8500 mm Ø 60/90 mm, with
counter-weight, joints and fixed support
(to be not load with other accessories)



ATAST90
Connection for round bar
Ø 90 mm



CP-BR6
Anchorage plate
with rag bolts

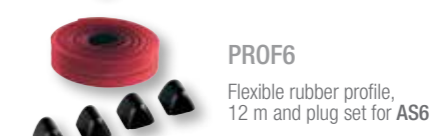

PROF6
Flexible rubber profile,
12 m and plug set for AS6